

Mounting Instruction SmartWing



SMARTEQTM
■ ■ ■ ■ ■ W I R E L E S S

Kista, Sweden
www.smarteq.com
info@smarteq.com
+46 8 792 92 00

500006E

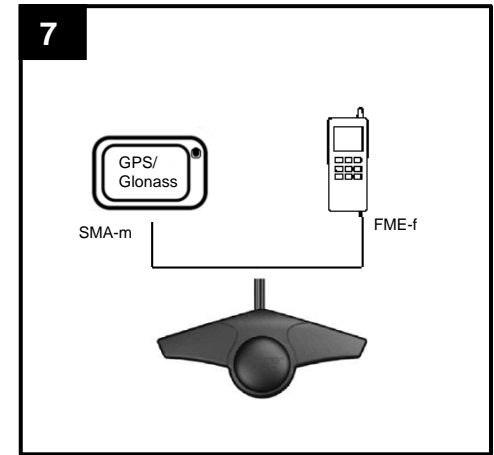
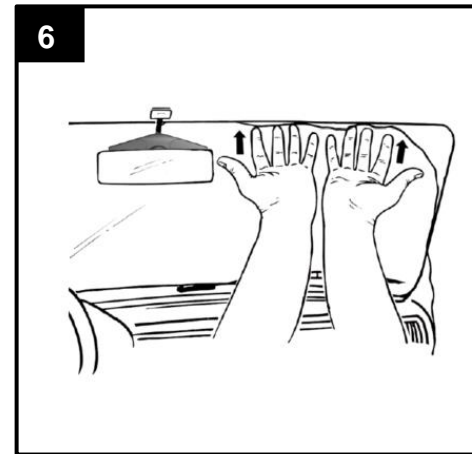
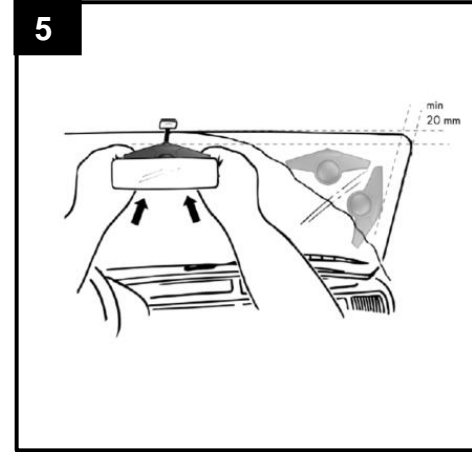
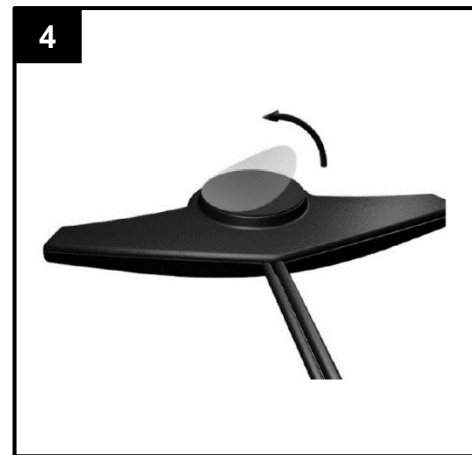
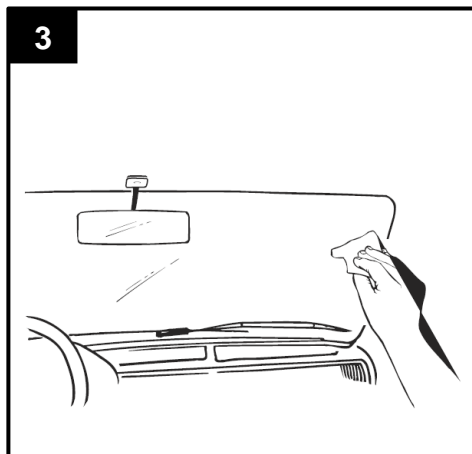
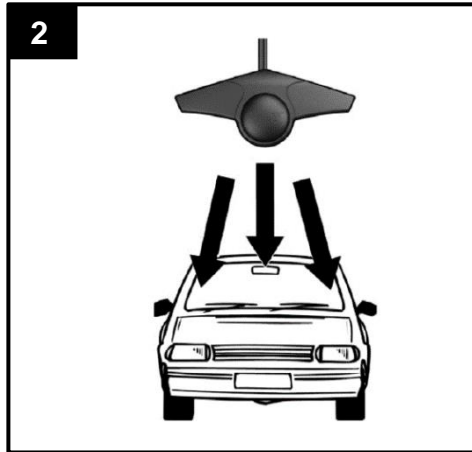
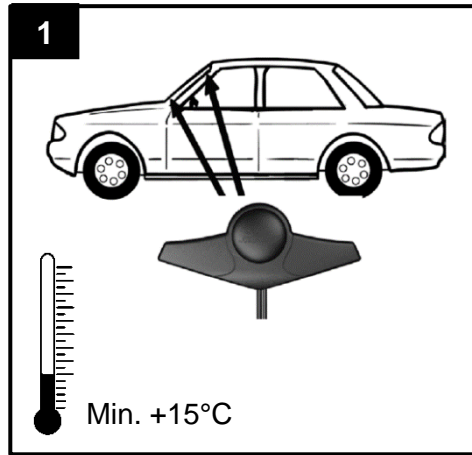

ATTENTION
OBSERVE PRECAUTIONS
FOR HANDLING
ELECTROSTATIC
SENSITIVE DEVICES

Hereby, Smarteq Wireless AB declares that the radio equipment type 'SmartWing LTE' is in compliance with Directive 2014/53/EU. The full text of the EU declaration of conformity is available at the following internet address: www.smarteq.com